

COUNTER-CURRENT SWIMMING JETVAG



730001 **Model 2,37 CV - Mono 230 V, 50 Hz**
with pump

Weight: 29 kg

**Rabat
Group**
A

730002 **Model 3 CV - Mono 230, 50 Hz**
with pump

Weight: 30,5 kg

A

730003 **Model 4 CV - TRI 230/400 V, 50 Hz**
with pump

Weight: 31 kg

A

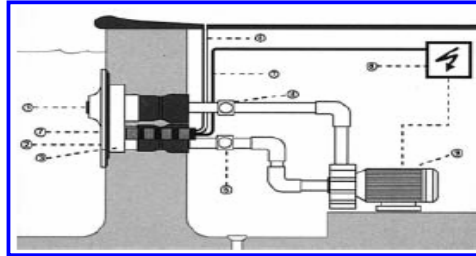

ACCESSORIES

730005 **Stainless handle**

**Rabat
Group**
A



730006 **Massage inlet JET**

A



730007 **Massage pipe**

A

COUNTER-CURRENT SWIMMING - DELTA

Wall fitting + completion set

Wall fitting, completion set, i.e. pump, control, set of connection fittings, ABS mask.



730036 DELTA 700
mask ABS

2,0 kW/230 V

Flow: 42 m³/h

**Rabat
Group**
A

730037 DELTA 750
mask ABS

2,6 kW/400 V

Flow: 48 m³/h

A

COUNTER-CURRENT SWIMMING - JETSTREAM

New more attractive design, air and water control in many options. Application of quality material.

FOR CONCRETE POOL

						Rabat Group
	730010 JETSTREAM Flow: 40 m3/h	2,3 kW	Mono 230 V	50 Hz		A
	730011 JETSTREAM Flow: 40 m3/h	2,3 kW	TRI 380 V	50 Hz		A
	730012 JETSTREAM Flow: 45 m3/h	2,76 kW	TRI 380 V	50 Hz		A
	730013 JETSTREAM Flow: 70 m3/h	3,26 kW	TRI 380 V	50 Hz		A
	730014 JETSTREAM Flow: 78 m3/h	4,04 kW	TRI 380 V	50 Hz		A
	730015 JETSTREAM Flow: 88 m3/h	4,71 kW	TRI 380 V	50 Hz		A

FOR LINER POOL

						Rabat Group
	730016 JETSTREAM Flow: 40 m3/h	2,3 kW	Mono 230 V	50 Hz		A
	730017 JETSTREAM Flow: 40 m3/h	2,3 kW	TRI 380 V	50 Hz		A
	730018 JETSTREAM Flow: 45 m3/h	2,76 kW	TRI 380 V	50 Hz		A
	730019 JETSTREAM Flow: 70 m3/h	3,26 kW	TRI 380 V	50 Hz		A
	730020 JETSTREAM Flow: 78 m3/h	4,04 kW	TRI 380 V	50 Hz		A
	730021 JETSTREAM Flow: 88 m3/h	4,71 kW	TRI 380 V	50 Hz		A

COUNTER-CURRENT SWIMMING - NEPTUN

Wall fitting

		Rabat Group
	730030 NEPTUN ABS for concrete pool	A
	730031 NEPTUN ABS for liner pool	A
	730032 NEPTUN ABS for polyester pool	A
	730033 NEPTUN Compact for concrete pool	A
	730034 NEPTUN Compact for liner pool	A
	730035 NEPTUN Compact for polyester pool	A

Completion set

Completion set, i. E. pump, control, set of connection fittings, ABS mask

				Rabat Group
	730036 NEPTUN 800 mask: ABS	2,0 kW/230 V	Flow: 42 m3/h	A
	730037 NEPTUN 900 mask: ABS	2,6 kW/400 V	Flow: 48 m3/h	A
	730038 NEPTUN 1150 mask: ABS	4,0 kW/400 V	Flow: 60 m3/h	A
	730048 NEPTUN 800 mask: 1.4571	2,0 kW/230 V	Flow: 42 m3/h	A
	730049 NEPTUN 900 mask: 1.4571	2,6 kW/400 V	Flow: 48 m3/h	A
	730050 NEPTUN 1150 mask: 1.4571	4,0 kW/400 V	Flow: 60 m3/h	A
	730039 NEPTUN Compact 950 mask: ABS	2,6 kW/400 V	Flow: 51 m3/h	A
	730040 NEPTUN Compact 950 mask: 1.4571	2,6 kW/400 V	Flow: 51 m3/h	A
	730041 NEPTUN Compact 1200 mask: ABS	4,0 kW/400 V	Flow: 66 m3/h	A
	730042 NEPTUN Compact 1200 mask: 1.4571	4,0 kW/400 V	Flow: 66 m3/h	A

ACCESSORIES TO THE COMPLETATION SET NEPTUN



730043 **Stainless supporting loop NEPTUN 800/900/1000**
white coating

**Rabat
Group**
A

730044 **Stainless supporting loop NEPTUN 800/900/1000**
natural

A

730045 **Set of stop cocks 800**

A

730046 **Set of stop cocks 900/1000**

A



730047 **Massage hose**

A

NEPTUN WALL MASSAGE - 2 NOZZLES, 3 NOZZLES

720001 **Built-in set, 2 nozzles**

**Rabat
Group**
A

720002 **Built-in set, 3 nozzles**

A

720003 **Completion set for 2 nozzles**
Pump: 2,0 Kw/230 V

A

720004 **Completion set for 2 nozzles**
Pump: 2,6 kW/400 V

A

720005 **Completion set for 3 nozzles**
Pump: 3,3 kW/400 V

A

COUNTER CURRENT SWIMMING - BRONZE - TAIFUN DUO



710001 **Taifun duo**
built-in set, 24 cm

Rabat
Group
G



710007 **Taifun duo**
completion set, i.e. a 2,6 kW bronze pump, control,
set of connection fittings, V4A mask

G

ACCESSORIES TO THE BUILT-IN SET TAIFUN DUO



710002 **Flange set**

Rabat
Group
G

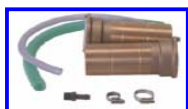

710003 **17 cm extension of the built-in set**

G



710004 **Set of elbows - 45° 2 1/2"**

G



710005 **Set of elbows - 90° 2 1/2"**

G

710006 **Blind flange, polished NiSn**

G

ACCESSORIES TO THE COMPLETION SET TAIFUN DUO



710008 **Handle V4A**

Rabat
Group
G



710009 **Taifun Duo massage hose with a blind flange**

G

710010 **Taifun Duo massage hose with a pulsating water jet
and blind flange**

G





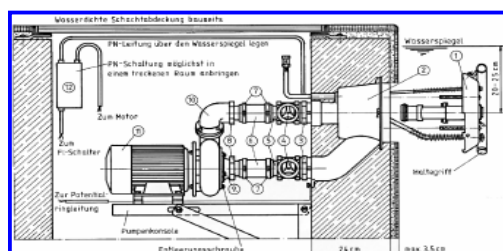

710011 **Console for the 1,5 - 2,2 - 2,6 kW pump**





G



COUNTERFLOW DEVICES - BRONZE - TAIFUN

	710012 Taifun built-in set, 24 cm	Rabat Group G
	710013 Taifun built-in set, 15 cm	G
	710014 Taifun completion set, i.e. a 2,6 kW bronze pump, control, set of connection fittings, ROUND MASK V4A	G
	710015 Taifun completion set, i.e. a 2,6 kW bronze pump, control, set of connection fittings, RECTANGULAR MASK V4A	G

ACCESSORIES TO THE BUILT-IN SET TAIFUN

	710002 Flange set	Rabat Group G
	710003 17 cm extension of the built-in set	G
	710004 Set of elbows - 45° 2 1/2"	G
	710005 Set of elbows - 90° 2 1/2"	G
	710006 Blind flange, polished NiSn	G

COUNTERFLOW - BRONZE - TORNADO

710020 **Tornado**
built-in set, 24 cm



710023 **Tornado**
completion set, i.e. a 2,6 kW bronze pump, control,
set of connection fittings, polished NiSn mask

**Rabat
Group**
G

G

ACCESSORIES TO THE BUILT-IN SET TORNADO

710021 **Flange set**

**Rabat
Group**
G



710003 **17 cm extension of the built-in set**

G



710004 **Set of elbows - 45° 2½"**

G



710005 **Set of elbows - 90° 2½"**

G

710022 **Blind flange, polished NiSn**

G

ACCESSORIES TO THE COMPLETATION SET TORNADO

710025 **Handle V4A**

**Rabat
Group**
G



710017 **Massage hose**

G

710018 **Massage hose** with a pulsating water jet

G

710019 **Massage nozzle** with a pulsating water jet

G



710011 **Console for the 1,5 - 2,2 - 2,6 kW pump**

G

SUSPENSION COUNTERFLOW DEVICES/STARTING BLOCKS



- 710027 **GSA**
Startblock, complete with a 2,6 kW pump
- 710028 **GSA**
Startblock, complete with a 1,5 kW pump

Rabat
Group
G

G

ACCESSORIES TO THE GSA STARTING BLOCKS

- 710029 **Massage plate as an alternative to the nozzle**
- 710017 **Massage hose**
- 710018 **Massage hose with a pulsating water jet**
- 710019 **Massage inlet with a pulsating water jet**

Rabat
Group
G

G

G

G

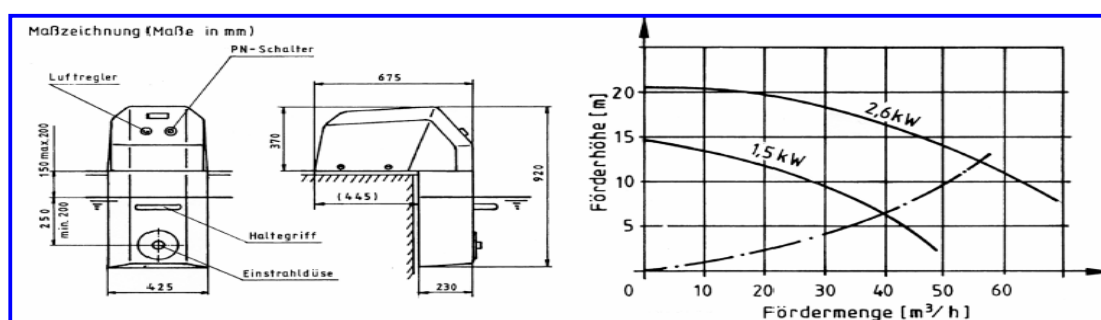

BOTTOM MESSAGE - AIR



710030 **Built-in set**, 90° outlet

710031 **Built-in set**, perpendicular outlet

710032 **Completion part** - blower 0,75 kw, backward valve, control box electropneumatic switch with safety element, massage plate - polished NiSn

710033 **Completion set for laminated pools** - 0,75 kW blower, return flap, control, pneumatic button, massage plate - polished NiSn



**Rabat
Group**
G

G

G

G

ACCESSORIES TO THE BOTTOM - AIR MESSAGE

710034 **Flange set for liner pools**

**Rabat
Group**
G

BOTTOM MESSAGE - WATER/AIR

710035 **Built-in set**



710036 **Completion set**, 2,2 kW pump, control, pneumatic button, massage plate - polished NiSn, **suction grid V4A**

710037 **Completion set**, 2,2 kW pump, control, pneumatic button, massage plate - polished NiSn, **white suction grid V4A**

**Rabat
Group**
G

G

G

STANDARD WALL MASSAGE DEVICE - 2 NOZZLES



710038 **Built-in set, 24 CM**

Rabat
Group
G

710039 **Completion set, 0,5 kW bronze pump, control, pneumatic button, suction grid V4A, nozzles - polished NiSn**

G



710040 **Completion set, 0,5 kW bronze pump, control, pneumatic button, white suction grid V4A, white nozzles**

G

710041 **Completion set for laminated pools, 0,5 kW bronze pump, control, pneumatic button, suction grid V4A, nozzles - polished NiSn**

G



710042 **Completion set for laminated pools, 0,5 kW bronze pump, control, pneumatic button, white suction grid V4A, white nozzles**

G

WATER GAMES COBRA INFINITY

510101 **Cobra - polished** Stainless steel: AISI 316
Capacity: 50 m³/h Connection: 75 mm
Height: 700 mm Width: 500 mm
Dimensiones basic plate: 265 x 265 mm

**Rabat
Group**
A

510102 **Cobra - brush polished** Stainless steel: AISI 316
Capacity: 50 m³/h Connection: 75 mm
Height: 700 mm Width: 500 mm
Dimensiones basic plate: 265 x 265 mm

A

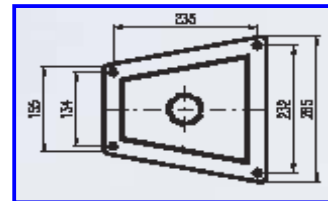
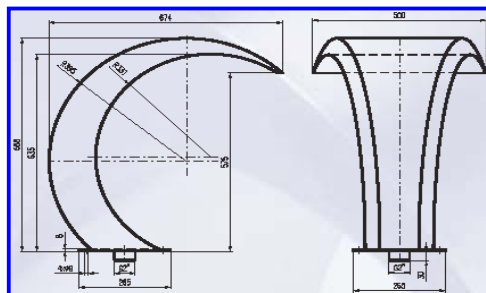

CANON INFINITY

510103 **Canon - polished** Stainless steel: AISI 316
Capacity: 30 m³/h Connection: 63 mm
Height: 820 mm Width: 210 mm
Dimensiones basic plate: 200 x 210 mm

**Rabat
Group**
A

510104 **Canon - brush polished** Stainless steel: AISI 316
Capacity: 30 m³/h Connection: 63 mm
Height: 820 mm Width: 210 mm
Dimensiones basic plate: 200 x 210 mm

A

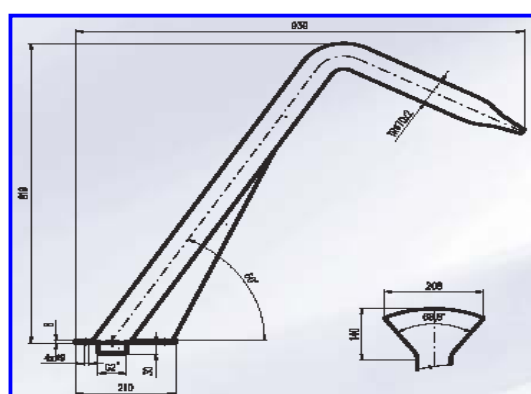
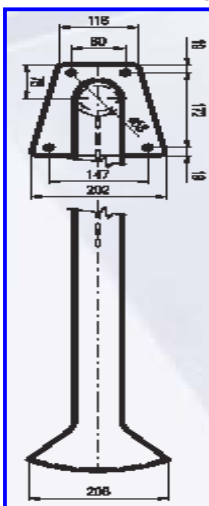

WATER GAMES BULL



740300 **Bull - brush polished**
Capacity: 50 m³/h

Stainless steel: AISI 316
Connection: 75 mm

**Rabat
Group**
A

LION

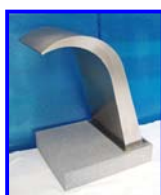

740301 **Lion - brush polished**
Capacity: 50 m³/h

Stainless steel: AISI 316
Connection: 75 mm

**Rabat
Group**
A

WATER GAMES FALL

AISI 316/L - V4A. Complete with counterflange to be cemented in place



740005	FALL 300 jet width mm. 300	L	Rabat Group G
740006	FALL 400 jet width mm. 400	L	G
740007	FALL 600 jet width mm. 600	*	G
740008	FALL 800 jet width mm. 800	*	G

HALFMOON

AISI 316/L - V4A. Complete with counterflange to be cemented in place

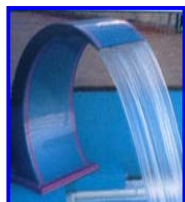

740009	HALFMOON M 325 jet width mm. 325	*	Rabat Group G
740010	HALFMOON M 500 jet width mm. 500	*	G
740011	HALFMOON M 625 jet width mm. 625	*	G

- * Colours on request: **SILVER/METALLIC BLUE - PEARL WHITE.**
- ▶ **L=Mirror finish. You are recommended to earth the installation.**
- ▶ For wooden packing, the cost will be charged separately.

COBRA

AISI 316 L - V4A STAINLESS STEEL FOUNTAIN



740012	MINI COBRA 300 jet width mm. 300		Rabat Group G
740013	MINI COBRA 500 jet width mm. 500		G
740014	COBRA 650 jet width mm. 650		G
740015	SUPER COBRA 800 jet width mm. 800		G

"SUNFLOWER"



740016	Ø 76 TYPE "MEDIO" with diffuser Ø 168		Rabat Group G
740017	Ø 89 TYPE "MAXI" with diffuser Ø 220		G

WATER GAMES "HERON"



740018 **Ø 76 TYPE "MEDIO"**
with nozzle Ø 27 - 33

740019 **Ø 89 TYPE "MAXI"**
with nozzle Ø 33 - 48

740020 **Ø 76 Fan outlet**
AV - mm. 200

740021 **Ø 89 Fan outlet**
AV - mm. 300

**Rabat
Group**
G

G

G

G

- ▶ All the fountains are complete with counterflange to be cemented in place.
- ▶ Colours available on request: silver/metallic blue pearl white.
- ▶ **You are recommended to earth the installation.**
- ▶ For wooden packing, the cost will be charged separately.

CANNON

AISI 316 L - V4A STAINLESS STEEL FOUNTAIN



740022 **CANNONE Ø 89** L
Jet width Ø 33/42

740023 **CANNONE Ø 114** L
Jet width Ø 42/48

**Rabat
Group**
G

G

FAN

Complete with counter flange to be cemented in place.

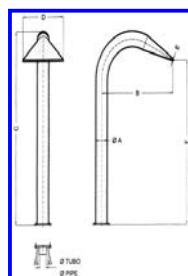

740024 **V - 300** Ø 76 *
jet width mm. 300

740025 **V - 400** Ø 89 *
jet width mm. 400

740026 **V - 500** Ø 114 *
jet width mm. 500

740027 **V - 170** 60 x 60 L
jet width mm. 170

740028 **V - 250** 80 x 80 L
jet width mm. 250

**Rabat
Group**
G

G

G

G

G

WATER GAMES NOZZLE

Complete with counter flange to be cemented in place.

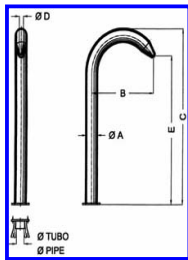

740029	U	Ø 60	L
		Jet width Ø 27	
740030	U	Ø 89	L
		Jet width Ø 33/42	
740031	U	Ø 114	L
		Jet width Ø 42/48	

**Rabat
Group**
G

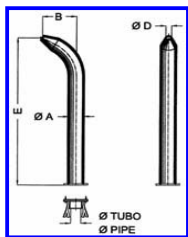

740032	UD	Ø 60	L
		Jet width Ø 27	
740033	UD	Ø 89	L
		Jet width Ø 33/42	
740034	UD	Ø 114	L
		Jet width Ø 42/48	

G

G

G

- * Colours on request: **SILVER/METALLIC BLUE - PEARL WHITE.**
- ▶ **L=Mirror finish.**
- ▶ For wooden packing, the cost will be charged separately.

WATER HEDGEHOG

AISI 316 L - V4A STAINLESS STEEL

A water game with thin spray capillary diffusion. Complete with shell, column and base ring nut and flange to be cemented into paving: the whole has a mirror finish.



740035	168	Ø 168 mm = 300/500
740036	250	Ø 250 mm = 300/500
740037	500	Ø 500 mm = 300/500
740038	500	Ø 500 mm = 500/700
740039	500	Ø 500 mm = 500/900



**Rabat
Group**
G

G

G

G

G

PLAY OF WATER CONTROL PANEL

740040	220 V	monofase
740041	220 V/380 V	trifase
740042	Pneumatic key and converter	

**Rabat
Group**
G

G

G

- ▶ For wooden packing, the cost will be charged separately.

WATER GAMES MUSHROOM

AISI 316 L - V4A STAINLESS STEEL FOUNTAINS

Counterflange to be cemented in place is not included in the price!



a) VTR FIBERGLASS

740043	800	Column: Ø 114
740044	1000	Column: Ø 140
740045	1200	Column: Ø 168
740046	1600	Column: Ø 220
740047	2000	Column: Ø 273
740048	2400	Column: Ø 273

b) STAINLESS STEEL

740049	800	Column: Ø 114
740050	1000	Column: Ø 140
740051	1200	Column: Ø 168
740052	1600	Column: Ø 220
740053	2000	Column: Ø 273

*

*

**Rabat
Group**

G
G
G
G
G
G

G
G
G
G
G

* Stainless steel with metallic silver stoved paint finish

MUSHROOM - STAINLESS STEEL COUNTERFLANGE

740054	For mushroom fountain - type 800 - 1000
740055	For mushroom fountain - type 1200 - 1600
740056	For mushroom fountain - type 2000 - 2400

**Rabat
Group**

G
G
G

► For wooden packing, the cost will be charged separately.

"TUBULAR FALL"

Mirror finish. AISI 316 L - V4A, stainless steel fountains.

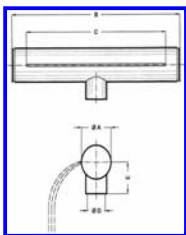

740057	TC1 300 Ø 60 = jet width mm. 250
740058	TC1 400 Ø 60 = jet width mm. 350
740059	TC1 500 Ø 60 = jet width mm. 450
740060	TC2 600 Ø 76 = jet width mm. 550
740061	TC3 750 Ø 89 = jet width mm. 700
740062	TC3 1000 Ø 89 = jet width mm. 950

**Rabat
Group**

G
G
G
G
G
G

WATER GAMES "HYDROJET"

Complete with counteflange to be cemented in place.
Mirror finish or varnish.

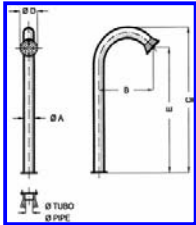

740063 **H 76**
Ø 76 = jets n. 13

740064 **H 89**
Ø 89 = jets n. 19

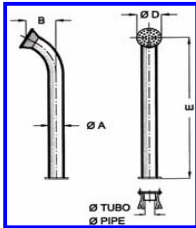

740065 **HD 76**
Ø 76 = jets n. 13

740066 **HD 89**
Ø 89 = jets n. 19

Rabat
Group
G

G

G

G

ORIZZONTAL

AISI 316 L - V4A STAINLESS STEEL FOUNTAINS DECORATIVE FALLS
(to insert into the beton)

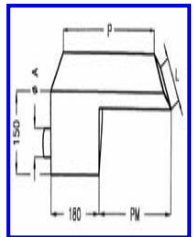

740067 Jet width mm. 330

740068 Jet width mm. 500

740069 Jet width mm. 750

740070 Jet width mm. 1000

Rabat
Group
G

G

G

G

VERTICAL "STANDARD"

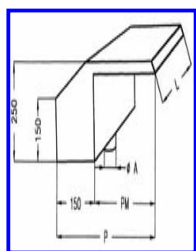

740071 Jet width mm. 330

740072 Jet width mm. 500

740073 Jet width mm. 750

740074 Jet width mm. 1000

Rabat
Group
G

G

G

G

VERTICAL "TIGHT"

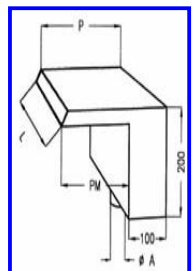

740075 Jet width mm. 200

740076 Jet width mm. 300

740077 Jet width mm. 400

740078 Jet width mm. 500

Rabat
Group
G

G

G

G

WATER GAMES

WATER UMBRELLA

A water game with a 360° jet of water. It comes complete with column, protection ring nut and flange to be cemented into paving: the whole has a mirror finish.



- 740079 OPEN
Ø 170 mm - h. 2500
- 740080 OPEN
Ø 220 mm - h. 2500

Rabat
Group
G

G

You are recommended to earth the installation.

- For wooden packing, the cost will be charged separately.

UP - UGELLO

AISI 316 L - V4A STAINLESS STEEL FOUNTAIN
Mirror finish.



- 740081 **UP-UGELLO** Ø 60
Jet width Ø 27
- 740082 **UP-UGELLO** Ø 89
Jet width Ø 27

Rabat
Group
G

G

VP - FAN

Mirror finish.



- 740083 **VP-120** 60 x 60
jet width mm. 120
- 740084 **VP-170** 60 x 60
jet width mm. 170
- 740085 **VP-250** 80 x 80
jet width mm. 250
- 740086 **VP-400** 100 x 100
jet width mm. 400

Rabat
Group
G

G

G

G

CERVICAL FAN

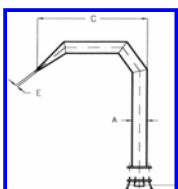

- 740087 **VC-170** 60 x 60
jet width mm. 170
- 740088 **VC-250** 80 x 80
jet width mm. 250

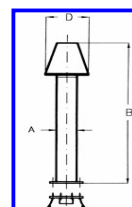

Rabat
Group
G

G

STAINLESS STEEL DIVING BOARDS

BTX

H. 0.60: type **RANA** - Complete with two stainless steel arch supports Ø 45.

740089 **DELUXE** mt. 1,85
Complete with board

740090 **DELUXE** mt. 2,4
Complete with board

740091 **Stainless steel pair of supports (rana) Ø 45**

740092 **Complete Kit for fixing boards**

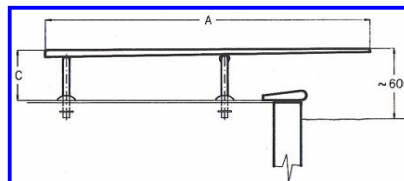

Rabat Group
G

G

G

G

ROMA

H. 0.60: (water level) Complete with handrail and AISI 304-V2A. Stainless steel installation kit.

740093 **DELUXE** mt. 1,85
Complete with board

740094 **DELUXE** mt. 2,4
Complete with board



Rabat Group
G

G

MAX

H.O.60: type **KANGURO** - Complete with AISI 304-V2A stainless steel column and counter flange to be cemented in place.

740095 **DELUXE** mt. 1,85
Complete with board

740096 **DELUXE** mt. 2,4
Complete with board

740097 **Difference for stainless steel counter flange**

740098 **Column stainless steel support** for diving-board type - MAX H. 0.60 (for board mt. 1.85) complete with counter flange and kit for installation board

740099 **Column stainless steel support** for diving-board type - MAX H. 0.60 (for board mt. 2.40) complete with counter flange and kit for installation board



Rabat Group
G

G

G

G

G

MAX - P

H.O.60: (water level) with column and AISI 304-V2A handrail complete with cold zinc counter flange to be cemented in place.

740100 **DELUXE** mt. 1,85
Complete with board

740101 **DELUXE** mt. 2,4
Complete with board

740102 **Difference for stainless steel counter flange**



Rabat Group
G

G

G

MAX - H

H. 0,80 (water level) with column and AISI 304 handrail complete with cold zinc counter flange to be cemented in place.

740103 **DELUXE** mt. 2,4
Complete with board

740104 **DELUXE** mt. 3,0
Complete with board

740105 **Difference for stainless steel counter flange**



Rabat Group
G

G

G

MAX - H

H. 1,00 (water level) with column and AISI 304 handrail (Ø 43) complete with cold zinc counter flange to be cemented in place.

740106 **DELUXE** mt. 2,4
Complete with board

740107 **DELUXE** mt. 3,0
Complete with board

740108 **Difference for stainless steel counter flange**



Rabat Group
G

G

G

HX

! FOR PUBLIC SWIMMING POOLS !

Rabat
Group
G

- 740109 **HX - H. 1.00**
with AISI 316-V4A stainless steel column and AISI 304-V2A stainless steel ladder and handrail, stainless steel adjustable fulcrum with DELUXE board mt. 4.30

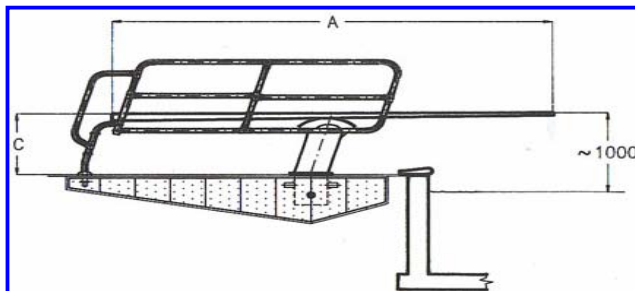

- 740110 **HX - H. 2.00**
with AISI 316-V4A stainless steel column and AISI 304-V2A stainless steel ladder and handrail, stainless steel adjustable fulcrum with DELUXE board mt. 4.90

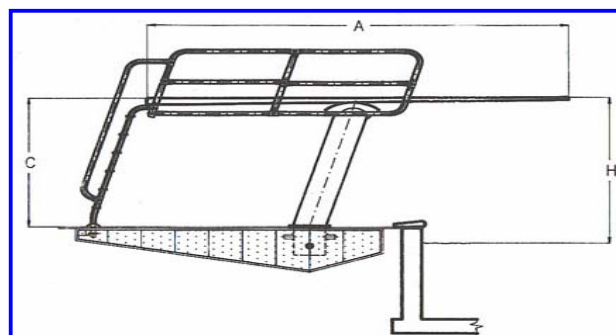

- 740111 **HX - H. 3.00**
with AISI 316-V4A stainless steel column and AISI 304-V2A stainless steel ladder and handrail, stainless steel adjustable fulcrum with DELUXE board mt. 4.90

G

G

BOARDS

made of fiberglass with three special wooden reinforcing boards

- 740112 **DELUXE mt. 1.85**
fiberglass reinforced board
- 740113 **DELUXE mt. 2.40**
fiberglass reinforced board
- 740114 **DELUXE mt. 3.00**
fiberglass reinforced board
- 740115 **DELUXE mt. 4.30**
fiberglass reinforced board
- 740116 **DELUXE mt. 4.90**
fiberglass reinforced board

Rabat
Group
G

G

G

G

G

AIR HYDRO-MASSAGE BEDS

AISI 316/L - V4A



740117 **Single bed**
width 250 mm for concrete

Rabat
Group
G

740118 **Double bed**
width 270 mm for concrete

G



740119 **Single bed**
width 200 mm for liner

G

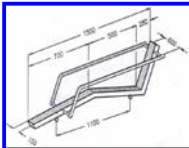

740120 **Single bed complete with handrail**

G



740121 **Double bed complete with handrail**

G

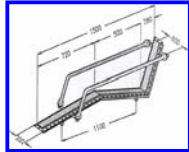

740122 **Single bed complete with handrail for liner**

G

HYDRO-MASSAGE ARM-CHAIR

740123 **Single arm-chair**
with handrail

Rabat
Group
G



740124 **Double arm-chair**
with handrail

G

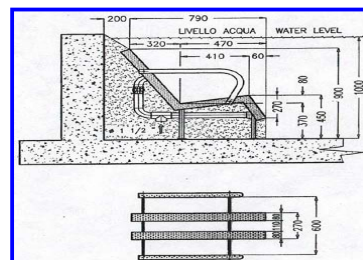

740125 **Single arm-chair**
complete with handrail for liner

G

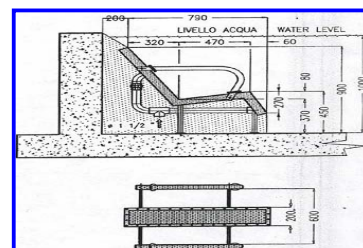

INLET FITTINGS - FLOOR TYPE

AISI 316 L - V4A STAINLESS STEEL. It has a mirror finish.

Rabat
Group
G

740001 **FIXED FOR AIR** threaded 2"
for concrete pool



740002 **FIXED FOR AIR** threaded 2"
for liner pool

G

740003 **FIXED FOR AIR** threaded 3"
for concrete pool

G



740004 **FIXED FOR AIR** threaded 3"
for liner pool

G

ACCESSORIES

SUCTIONS

**AISI 316 L - V4A STAINLESS STEEL
(THROUGH WALL FITTING)**



AISI 304 = V2A STAINLESS STEEL

			Rabat Group
740126	Threaded 3" for concrete pool	Ø 168	G
740127	Threaded 4" for concrete pool	Ø 220	G
740128	Flanged DN 125 for concrete pool	Ø 273	G
740129	Flanged DN 150 for concrete pool	Ø 320	G
740130	Threaded 3" for liner coating	Ø 168	G
740131	Threaded 4" for liner coating	Ø 220	G
740132	Flanged DN 125 for liner coating	Ø 273	G
740133	Flanged DN 150 for liner coating	Ø 320	G

SUCTION FOR FOUNTAINS - (THREADED)

AISI 316 L - V4A STAINLESS STEEL

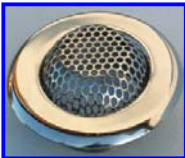
It has a mirror finish.

			Rabat Group
	740134 Threaded M 3" for concrete pool		G
	740135 Threaded M 4" for concrete pool		G
	740136 Threaded M 5" for concrete pool		G
	740137 Threaded M 3" for liner pool		G
	740138 Threaded M 4" for liner pool		G
	740139 Threaded M 5" for liner pool		G

WALL SAFETY GRILLE WITH RAPID ATTACHMENT

(without hose fitting)



Product Code	Description	Dimensions	hose/pipe	Rabat Group
740140	Rapid attachment Ø 120 for concrete pool	Ø 120	75/90	G
740141	Rapid attachment Ø 145 for concrete pool	Ø 145	90/110	G
740142	Rapid attachment Ø 180 for concrete pool	Ø 180	125/140	G

SUCTION FOR FOUNTAINS - COVER GRILLE

AISI 316 L - V4A STAINLESS STEEL

It has a mirror finish.



Product Code	Description	Dimensions	Rabat Group
740143	Ø 168 for concrete pool	Ø 168	G
740144	Ø 220 for concrete pool	Ø 220	G
740145	Ø 273 for concrete pool	Ø 273	G
740146	Ø 320 for concrete pool	Ø 320	G
740147	Ø 168 for liner pool	Ø 168	G
740148	Ø 220 for liner pool	Ø 220	G
740149	Ø 273 for liner pool	Ø 273	G
740150	Ø 320 for liner pool	Ø 320	G

WALL SAFETY - GRILLE

*SQUARE TYPE - ONLY GRILLE



Product Code	Description	Dimensions	Rabat Group
740151	Cover grille	240 x 240 mm	G
740152	Cover grille	290 x 290 mm	G
740153	Cover grille	390 x 390 mm	G
740154	Cover grille	490 x 290 mm	G
740155	Cover grille	600 x 390 mm	G

***FRAME FOR SAFETY - GRILLE**
SQUARE TYPE - for concrete

			Rabat Group
740156	for concrete	mm 240 x 240 x 3"	G
740157	for concrete	mm 290 x 290 x 4"	G
740158	for concrete	mm 390 x 390 x 5"	G
740159	for concrete	mm 490 x 290 x 2 x 4"	G
740160	for concrete	mm 600 x 390 x 2 x 5"	G

GRILLE COMPLETE WITH FRAME
SQUARE TYPE - for liner

			Rabat Group
740161	for liner	mm 240 x 240 x 3"	G
740162	for liner	mm 290 x 290 x 4"	G
740163	for liner	mm 390 x 390 x 5"	G
740164	for liner	mm 490 x 290 x 2 x 4"	G
740165	for liner	mm 600 x 390 x 2 x 5"	G

RECTANGULAR TYPE



			Rabat Group
740166	Cover grille	330 x 720 mm	G
740167	Cover grille	330 x 950 mm	G

HYDROMASSAGE INLET

AISI 316 L - V4A STAINLESS STEEL
Complete with body and orientable inlet!

			Rabat Group
	740168 Wall inlet Standard for concrete	threaded: 1 ½"	G
	740169 Wall inlet Standard for concrete	threaded: 2"	G
	740170 Wall inlet Standard for concrete	threaded: 3"	G
	740171 Wall inlet Standard for liner	threaded: 1 ½"	G
	740172 Wall inlet Standard for liner	threaded: 2"	G
	740173 Wall inlet Standard for liner	threaded: 3"	G
	740174 Wall inlet De Luxe for concrete	threaded: 1 ½"	G
	740175 Wall inlet De Luxe for concrete	threaded: 2"	G
	740176 Wall inlet De Luxe for liner	threaded: 1 ½"	G
	740177 Wall inlet De Luxe for liner	threaded: 2"	G
	740178 Inlet floor for concrete	threaded: 2"	G
	740179 Inlet floor for liner	threaded: 2"	G
	740180 Through 1" for concrete	long. 150 mm	G
	740181 Through 1" for concrete	long. 200 mm	G
	740182 Through 1" for concrete	long. 250 mm	G

HYDROMASSAGE INLET

AISI 316 L - V4A STAINLESS STEEL



740183 **Wall inlet** for concrete threaded: 2"

Rabat
Group
G



740184 **Wall inlet** for liner threaded: 2"

G



740185 **Inox hydromassage mini inlet (with 5 holes)** threaded: 3/8"

G

740186 **Inox hydromassage mini inlet (with 5 holes)** threaded: 1/2"

G

740187 **Inox hydromassage mini inlet (with 7 holes)** threaded: 3/4"

G

ABS WALL HYDRO-MASSAGE INLET FITTINGS



740188 **STANDARD** type adjustable for concrete
Cover flange Ø 90 mm. Attach.: water Ø 33 - air Ø 25 mm

Rabat
Group
G



740189 **STANDARD** type adjustable for liner
Cover flange Ø 90 mm. Attach.: water Ø 33 - air Ø 25 mm

G



740190 **Rotor** type for concrete
Cover flange Ø 110 mm. Attach.: water Ø 33 - air Ø 25 mm

G



740191 **Rotor** type for liner
Cover flange Ø 110 mm. Attach.: water Ø 33 - air Ø 25 mm

G



740192 **Standard** type with 7 jets for concrete
Cover flange Ø 110 mm. Attach.: water Ø 33 - air Ø 25 mm

G



740193 **Standard** type with 7 jets for liner
Cover flange Ø 110 mm. Attach.: water Ø 33 - air Ø 25 mm

G

740194 **Stainless steel cover**
AISI 316/L

G

PNEUMATIC BUTTON



740195 **Pneumatic button ABS**

Rabat
Group
G



740196 **AISI 316 button switch with base**
complete with 1 button

G



740197 **AISI 316 button switch with base**
complete with 2 buttons

G



740198 **AISI 316 button switch with base**
complete with 3 buttons

G

ABS SUCTION



740199 **STANDARD**
attachments 1 ½"

**Rabat
Group**
G



740200 **STANDARD**
attachments 2"

G

740201 **STANDARD**
attachments 2 ½"

G

GRILLE - STANDARD TYPE

AISI 316 L - V4A STAINLESS STEEL

740202 **GRILLE** 20 X 20 cm with frame
for concrete

**Rabat
Group**
G



740203 **GRILLE** 25 x 25 cm with frame
for concrete

G

740204 **GRILLE** 30 x 30 cm with frame
for concrete

G

740205 **GRILLE** 40 x 40 cm with frame
for concrete

G

740206 **GRILLE** 50 x 50 cm with frame
for concrete

G

GRILLE - STANDARD TYPE

AISI 316 L - V4A STAINLESS STEEL

740207 **GRILLE** 20 X 20 cm with frame
for liner

**Rabat
Group**
G

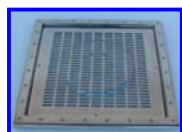

740208 **GRILLE** 25 x 25 cm with frame
for liner

G

740209 **GRILLE** 30 x 30 cm with frame
for liner

G

740210 **GRILLE** 40 x 40 cm with frame
for liner

G

740211 **GRILLE** 50 x 50 cm with frame
for liner

G

GRILLE - DIN NORMS

AISI 316 L - V4A STAINLESS STEEL. It has a mirror finish.



740212	GRILLE for concrete	30 x 30 cm	with frame	Rabat Group G
740213	GRILLE for concrete	40 x 40 cm	with frame	G
740214	GRILLE for concrete	50 x 50 cm	with frame	G
740215	GRILLE for liner	30 x 30 cm	with frame	Rabat Group G
740216	GRILLE for liner	40 x 40 cm	with frame	G
740217	GRILLE for liner	50 x 50 cm	with frame	G